

Specification

Narrow Belt Sorter

Photo

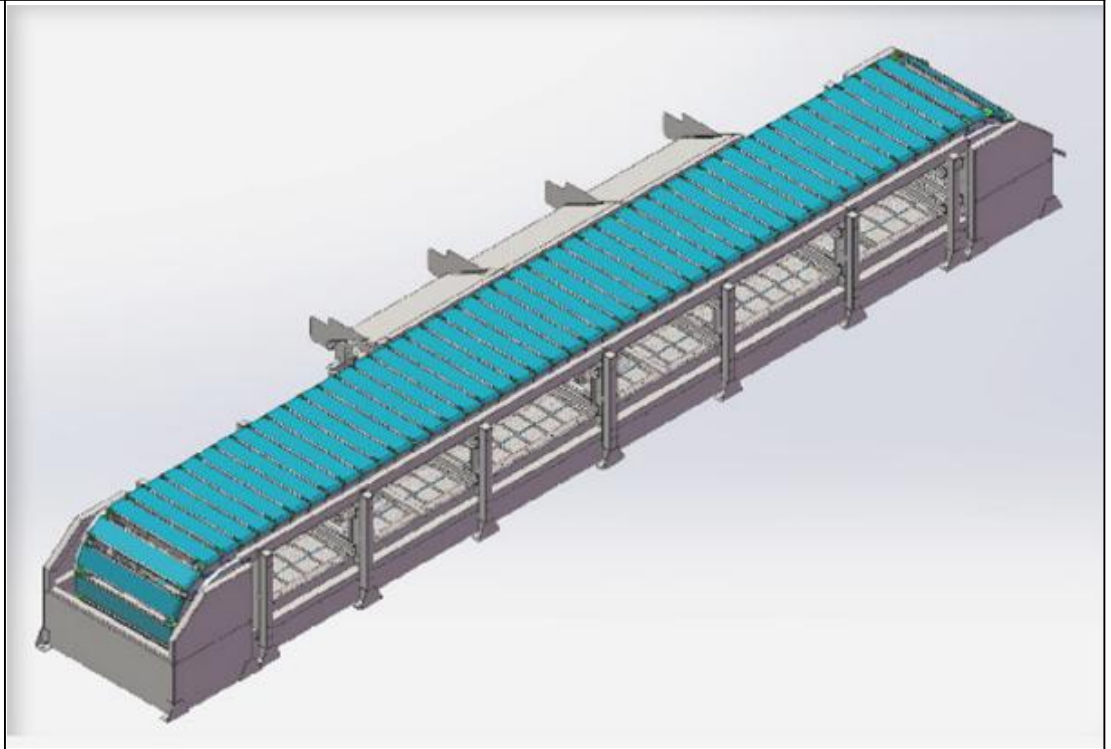

descriptive	Parameter description	note
Maximum cargo size mm	L2000*W1000*H700	adaptable
Minimum cargo size mm	L100*W100*H5	
Maximum cargo weight kg	70kg	
Minimum cargo weight kg	0.1kg	
Load capacity per meter kg	80kg	
running speed	1-2.5m/s	
Maximum Sorting Efficiency	10,000 pieces/hour (based on minimum shipment)	Conventional efficiency 6000
Maximum equipment length m	100m	customization



DWS Fully Automatic Weighing Scanning System

Trolley pitch mm	200mm	
trolley belt	Black PVC, low friction, small wrap-around corners	
Trolley running power	48V servo electric roller	forward and backward
Power per trolley KW	0.3KW	
Main travel power	Permanent magnet synchronous linear motor (single side drive)	
Linear motor power KW	0.75-1.5KW (according to the load, speed power change)	
Rated power of the whole machine KW	Trolley power + linear motor power	
operating noise	70 dB or less	One meter from equipment
Sorting correctness	99.99%	
Trolley power supply method	Slip wire (standard)	
Trolley communication method	Distributed Leakage Cable Wireless Communications	